

The Lancaster Campus of History

LancasterHistory.org—Lancaster County's Historical Society and President James Buchanan's Wheatland—has experienced more than a decade of pronounced change and growth, made possible by strong leadership, innovative educational programming, exceptional strategic planning, first-rate historical collections, and enthusiastic support from the community.

The Lancaster Campus of History will build on the strengths of LancasterHistory.org, and will transform Lancaster County's official historical society and Wheatland, a National Historic Landmark and the home of Pennsylvania's only U.S. President, into a new national model for historical learning and public programming. It will place Central Pennsylvania at the forefront of a movement exploring foundational themes of American history by demonstrating the relationship between local, regional, and national stories, events, and people, creating a center for critical reflection on America's past.

The centerpiece of the Campus of History will be a 19,755-sq-ft addition to the headquarters of Lancaster County's Historical Society to accommodate expanded programming for both Wheatland and the Historical Society, new research facilities, new archival, library, and collection storage areas, exhibition galleries, learning centers, conservation space, and a multi-use educational auditorium. Additionally, the project will include significant site enhancements to make the Campus more visitor-friendly, more park-like, and a model for responsible stewardship through a variety of "green technology" initiatives. The Campus of History, composed of Lancaster County's Historical Society headquarters and its new addition, as well as President James Buchanan's Wheatland, its outbuildings, and historic landscape, will offer a ten-acre park-like setting enhanced by the Louise Arnold Tanger Arboretum and the Wheatland Gardens.

Building on a solid track record of award-winning educational programs, LancasterHistory.org is well-positioned to explore historic themes and events under the rubric "County, Commonwealth, and Country." We are confident that the Campus of History will provide an engaging civics laboratory to investigate fundamental principles of American society and life at the local, state, and national levels that will lead citizens to a deeper understanding of important issues like religious tolerance, the quest for freedom and democracy, as well as the American presidency and national politics of the antebellum period.

A recently-awarded challenge grant from the National Endowment for the Humanities, being matched by LancasterHistory.org supporters on a three-to-one basis, will support a new roster of research fellowships and expanded humanities-based programming. Furthermore, as a LEED (Leadership in Energy and Environmental Design) Silver-Level project, the Campus of History will be a model of sustainability and will help set a new standard for environmental preservation among cultural organizations.

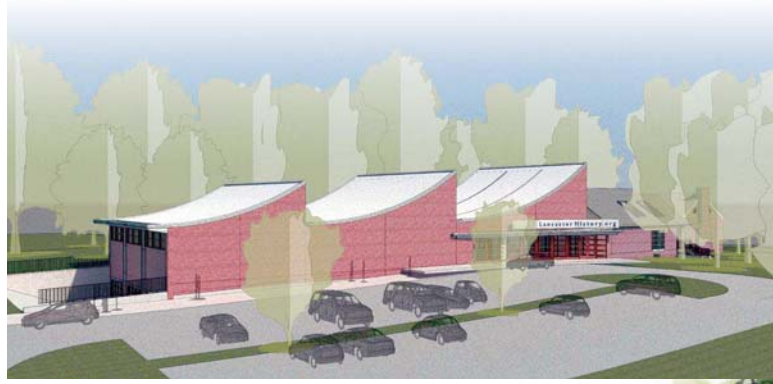

- A Wheatland Mansion (1828)
- B Original Willson Building (1956)
- C Henry Kauffman Wing (1998)
- D LancasterHistory.org Addition (2012)

- 1 Porous pavement and "orchard" parking
- 2 Underground wells for a geo-thermal heating and cooling system
- 3 Green building design
- 4 Solar hot water technology
- 5 Tanger Arboretum
- 6 Wheatland gardens
- 7 Wheatland lawn
- 8 Frog pond
- 9 Pedestrian-friendly campus core



Above: The 250-seat multi-use Auditorium and event space will adapt to lectures, school programs, meetings and events hosted by LancasterHistory.org and other community groups.

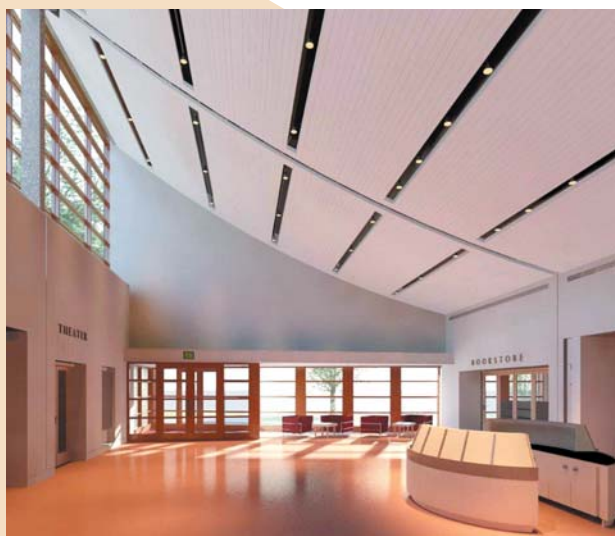

Left: Enhanced retail and guest information space will provide visitors with a superlative experience at the Campus of History. With a new orientation theater, snack options and ticketing for the Historical Society and Wheatland, individuals or groups will find everything onsite for a memorable day visit.

Green...and greener

Concern for our beautiful natural surroundings is a cornerstone for LancasterHistory.org. The new addition will utilize a variety of green initiatives to meet electrical needs, geothermal resources to heat and cool buildings and green roof technology to insulate the building and enhance the surrounding natural environment. Green design and building also have positive efficiency and cost-reduction attributes, helping to reduce heating and electrical expenses.

The new facilities will be constructed using sustainable technology to maximize utilization and enjoyment of the Campus of History while minimizing the carbon footprint.

Porous pavement that enables rain water to return to the ground, rather than run off into the Conestoga River, and an "orchard" parking configuration will ensure that even our parking areas enhance the sustainability of our site and environment.

Our goal is to achieve at least "Silver" LEED Leadership status with our addition to the building and the changes to its exterior. LEED is an internationally recognized green building certification system.

While it is our mission to preserve the history of Lancaster County, we are equally committed to saving the area's rich natural resources for the future!

NAME
ADDRESS
CITY, ST, ZIP

For generations of Lancasterians, preserving the stories and treasures of our past has been a pressing concern. More than 125 years ago, a call went out from several of Lancaster's leading citizens for the creation of a historical society bent on gathering and preserving the materials relating to the history of Lancaster County. At that moment, Lancaster County's Historical Society—now LancasterHistory.org—was born.

And, for nearly as long as the historical society has existed, it has wrestled with the question of how and where Lancaster's tales and treasures should be stored and shared. In the early decades of the twentieth century it was 307 North Duke Street. Beginning in 1956, the



Above: Construction of the Willson Building at 230 North President Avenue. (1956)

home of Lancaster's history was 230 North President Avenue, on a parcel of land once owned by President James Buchanan. Only fifteen years ago, thanks to a generous bequest given by the late Henry J. Kauffman, the historical society building grew once more to better accommodate the growing collections and visitor base in the Kauffman Wing.

In 2006, sixty-five community members, friends, neighbors, leaders, students, history colleagues, staff, and volunteers of Lancaster County's Historical Society and President James Buchanan's Wheatland, gathered to cast their gaze to the future. We came upon a vision of the past that could guide us into the future; a way of looking at the past that places Lancaster County's history in the broader context of America's history. Now, with years of planning and success, we are in a strong position to move forward with our plans to create the Lancaster Campus of History at the corner of Marietta and President Avenues.

Our strategic plan for the creation of the Campus of History has led us to design a capital campaign that will help us meet our financial needs for the building, add funds to our endowment for programming inside our new addition, and make sure we have all the assets we need to keep us on the sound financial footing we have worked to create. Our fundraising goal is \$13.5 million. To date, we have raised \$11.3 million, and our work is not finished.

Your support is crucial to helping us reach our goal! In these pages, and the newsletters to come, you will find details on our plans for the Lancaster Campus of History, the new addition to the historical society building, and our designs for LancasterHistory.org upon completion of the Campus of History at the end of 2012. You will also find information about critical ways that you can help make this project a reality, and help keep the treasures and stories of Lancaster County's past not only preserved for future generations, but accessible to them. To paraphrase Dr. Dubbs in 1887, whether you are able to support this project with a gift of money or a gift of "good feeling," we hope you will join us as we celebrate and preserve history in Lancaster County!

Thomas R. Ryan, PhD.
President & CEO, LancasterHistory.org

Judy S. Ware
Chair, Campaign Steering Committee

Let each one do what he can, and he will do exactly what he ought. Some can give money; some can give books, pictures, or precious heirlooms of the past; all can give good feeling and good words. But whatever is done, let it be done speedily, so that the present generation may atone in some degree for the neglect of the past, and our noble county rejoice in the prosperity of an institution which labors solely to promote her honor.

—Dr. Joseph Henry Dubbs
President of the Lancaster County Historical Society, 1887



Above: The original location of the historical society at 307 North Duke Street.

Bottom: The 1998 Kauffman Wing gave the society a new face.



Donor Walls Design Revealed. Be a Part of History!

Architects have completed their design of the permanent donor walls that will be at the main entrances of the new LancasterHistory.org building. Elegant etchings in glass will greet members, donors and visitors every day at the new building reminding all that generosity made this wonderful facility possible.

There will be a special "Major Donors Wall" of glass thanking all donors who make gifts of \$3,000 and more (Remember, gifts may be pledged over a period of up to 5 years). All donors of \$500 and more will be recognized as "Founding Donors" and their names will be included on a special etched wall of glass that will be a permanent feature in the new building.

There are still many wonderful naming opportunities for donors who make gifts of \$10,000 and more. Gifts may be made in honor of or in memory of a loved one, partner or friend. **Please contact Robin Sarratt for more details at (717) 392-4633, ext 117**

LancasterHistory.org thanks the many people who have already pledged to this campaign, and to those who are considering gifts as we close in on our campaign goal. As of the mailing of this newsletter we have formally raised \$11.3 million of our \$13.5 million. Campaign efforts will continue through 2012, so you still have time to be a part of history!



Timeline:

- August 31, 2011: Groundbreaking
- October 3, 2011: Major Construction Begins
- December 3, 2011: Lower level walls and basement floor in place
- January 16, 2012: Steel beams installed
- February 1, 2012: Ground level floor installed; walls begin to get in place
- March 19, 2012: Interior walls framed, last steel beam in place

SAVE THE DATE!

April 20, 2012: Celebration!
 We have a roof over our heads! ■

- July, 2012: Major interior work
- November, 2012: Building Complete
- January, 2013: Open to the public!

Campaign Steering Committee

- | | |
|-------------------------------|---|
| Judy S. Ware, <i>Chair</i> | Key Campaign Staff |
| Michael L. Abel | Thomas R. Ryan, Ph.D., <i>President & CEO</i> |
| Patrick Castagna | Robin E. Sarratt, <i>Vice President</i> |
| Dana Chryst | Todd T. Lindsley, <i>Campaign Consultant</i> |
| Wendell L. Funk, M.D. | |
| Eugene and Bernadette Gardner | |
| Robert F. Groff, Jr. | |
| Aileen Hamilton | |
| Barbara Hunsberger | |
| Deborah M. Martin | |
| William Regitz | |
| Rick Rodgers | |



Temporary Headquarters in Downtown Lancaster
 The historical society's temporary home, located at 4 West King Street in Lancaster City, has been a perfect landing spot for us during construction. We will remain here through January, 2013.



Groundbreaking: August 31, 2011

On August 31, 2011, staff and directors of LancasterHistory.org proudly broke ground on the Campus of History with the help and support of our state legislators, local dignitaries, members, friends, and donors. The groundbreaking ceremony for the Lancaster Campus of History began at 9am on a beautiful summer morning with remarks from President & CEO Thomas R. Ryan, Chairman of the Board Kathleen A. Gray, and Chair of the Campaign Steering Committee, Judy S. Ware. Representative Ryan Aument of the 41st District, Representative Michael Sturla from the 96th District, Senator Lloyd Smucker of the 13th District, and Mayor J. Richard Gray praised the project for the impact it will have on the visitors to and citizens of Lancaster County.

Building Plans: First Floor

A broad series of doors on the west side of the new lobby afford a view of the President's mansion and lead to an outdoor learning laboratory and event space. Winding paths, dotted with informational and educational signage, will emanate from this point, inviting visitors to discover more than 100 species of trees in the Tanger Arboretum and explore the historic beauty of the Wheatland garden and grounds.

The 250-seat, multi-use Auditorium and event space will adapt for lectures, school programs, meetings and events hosted by LancasterHistory.org and other community groups.

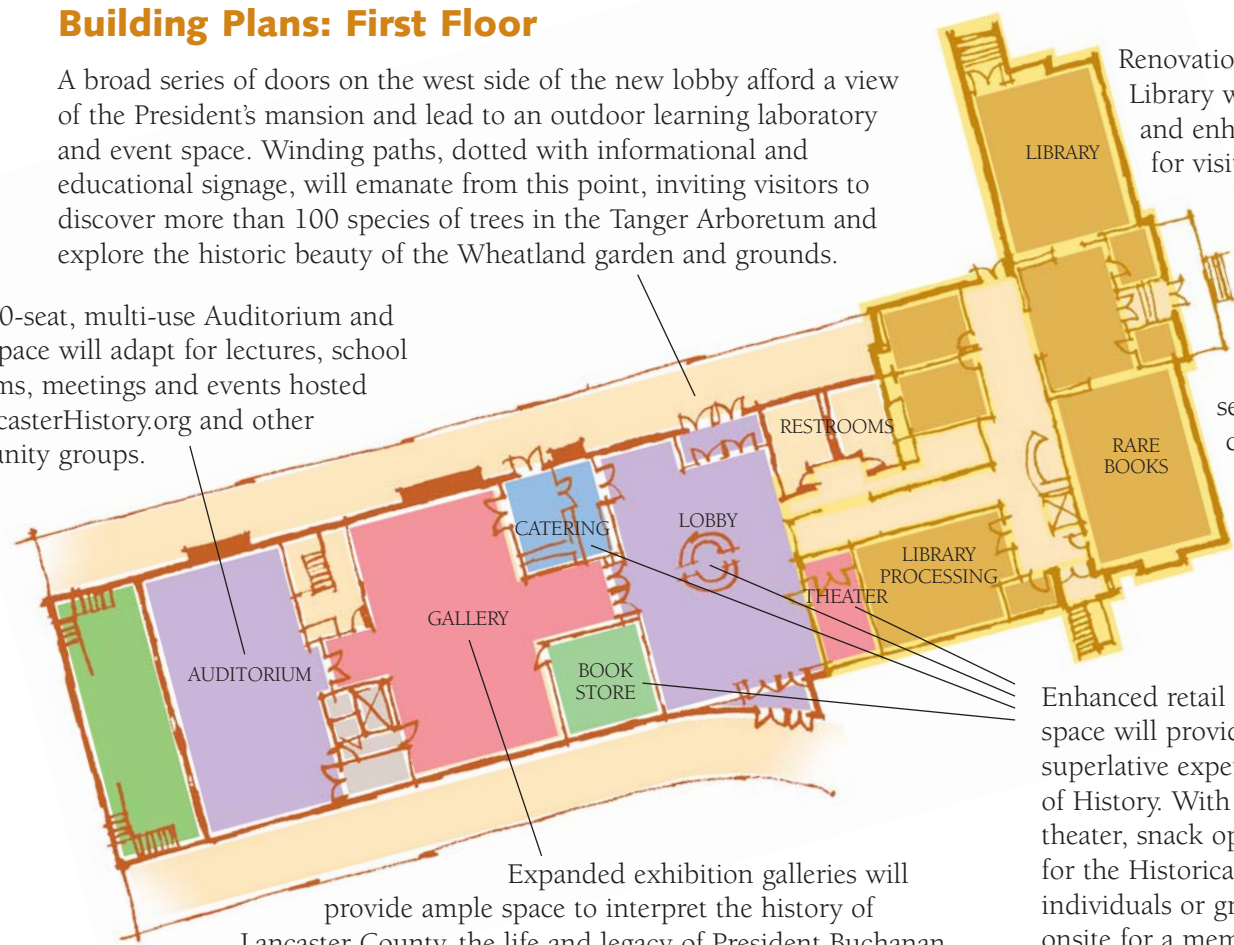

Renovations to the existing Library will relieve congestion and enhance the spaces available for visitors. A James Buchanan Rare Book Room will put scholars within reach of collections previously difficult to access. Digitized resources will be keyword searchable from new computer kiosks, streamlining the research process for thousands of patrons.

Enhanced retail and guest information space will provide visitors with a superlative experience at the Campus of History. With a new orientation theater, snack options and ticketing for the Historical Society and Wheatland, individuals or groups will find everything onsite for a memorable day visit.

Expanded exhibition galleries will provide ample space to interpret the history of Lancaster County, the life and legacy of President Buchanan, and key moments of American history.



Day 113: January 16, 2012

Steel beams are delivered, creating the foundation for our walls.



Great Progress: Day 143
February 24, 2012

With the concrete slabs in place creating the two floors, the masonry walls begin to go up.

Lower Level

Secure storage areas will ensure that the Library, Archival and Object Collections of the Historical Society, Wheatland and the County government will be preserved for future generations while also becoming easily accessible for research today.

New administrative spaces will simultaneously relieve limited quarters for staff and release space in the current building for the Library, exhibitions and educational interpretation.

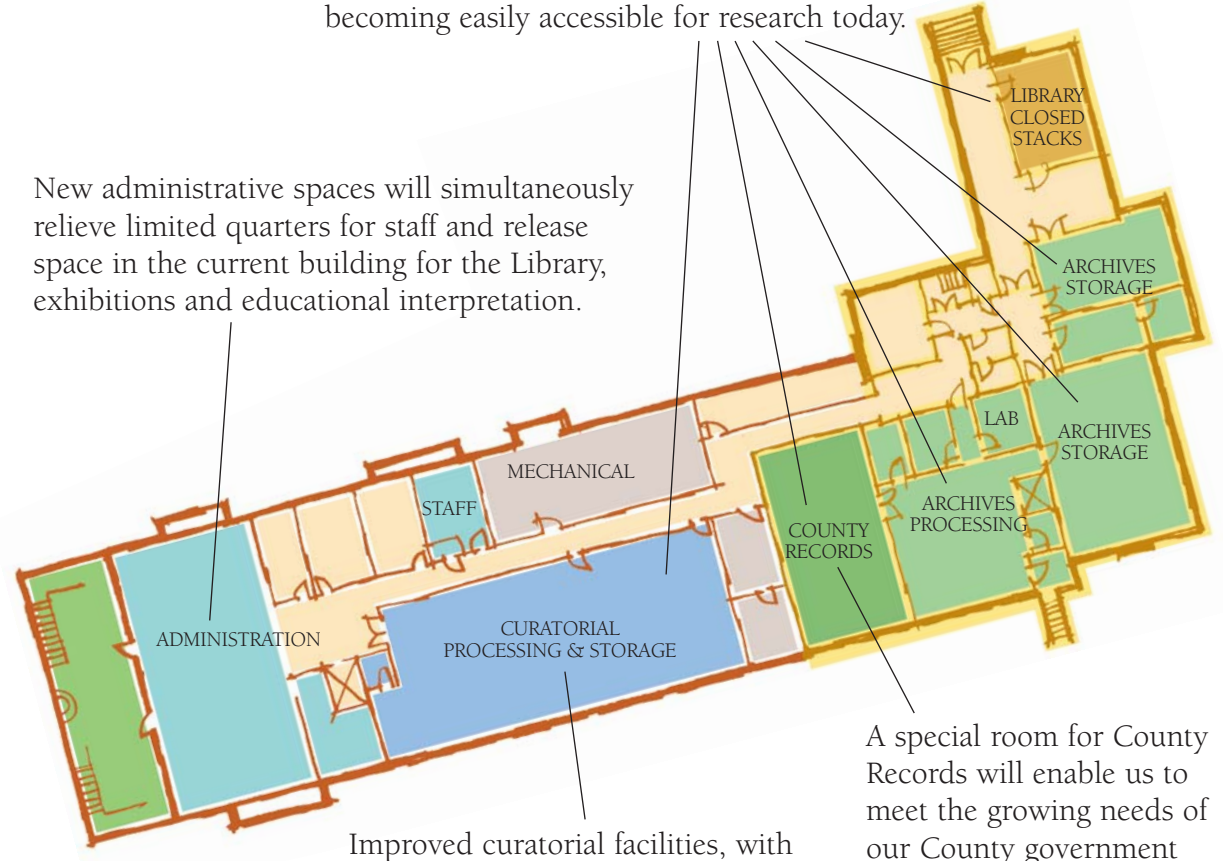

Improved curatorial facilities, with open storage and a hands-on study space, will enable researchers and students to learn directly from the objects representing nearly 300 years of history.

A special room for County Records will enable us to meet the growing needs of our County government to maintain the expanding collection of more than 600,000 official county records, performing a necessary public service for our region.

Additional parking facilities will provide ample spaces—including better access for handicapped visitors.

The Campus of History Architects, or, Connecticut Yankees in President Buchanan's Court

In 2006, as we began to consider the creation of the Lancaster Campus of History, we looked for guidance in our process of discovery and we found new friends at Centerbrook Architects and Planners, in Centerbrook, Connecticut. Mark Simon, Russell Learned, and Peter Cornell brought us an engaging process and fresh ideas that helped guide our work, shape our vision and inspired the design of a new, 19,755 square foot addition to the historical society building that will continue to inspire for years to come. So just who are these Connecticut architects?

Centerbrook Architects serves a diverse clientele, from universities and independent schools to arts organizations, homeowners, businesses, municipalities, and religious congregations. Founded in 1975 the firm is staffed by more than 60 professionals whose services encompass project management, planning, interior design, sculpture, landscape and site design, industrial design, furniture and lighting design and fabrication, fund raising support, and graphic design. Centerbrook has garnered more than 340 design awards, the most of any Connecticut firm. In 1998, the American Institute of Architects

recognized Centerbrook with its prestigious national Firm Award.

Remaining stalwart practitioners of "green" architecture, the firm has incorporated affordable conservation approaches into more than 50 projects, many of which are LEED certified. Its offices in a renovated 19th century mill building reflect its vision of sustainable architecture, and serves as a laboratory for testing efficient and renewable technologies. About 40 percent of the power that operates its offices is generated by on-site renewable energy sources using hydro, geothermal, and solar power.

Our design team is composed of three winning characters we have truly enjoyed working with: Mark Simon, Russell Learned, and Peter Cornell.



Mark Simon
 From the start of his career, Mark has been a pioneer in the practice of "green" architecture, beginning with his design in 1973 of an "earth house" that was built into a hillside and continues to this day to take advantage of the heating and cooling properties of *terra firma*. Today,

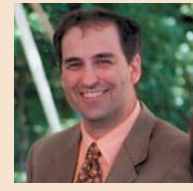

Russell Learned
 Russell received his Bachelor of Fine Arts from the University of Connecticut, Storrs in 1991 and a Master of Architecture from the University of Pennsylvania in 1994. He joined Centerbrook in 1995 and in 2004 was named an Associate in the firm. Russell

is a past president of the Connecticut Chapter of the American Institute of Architects and currently serves on the Board of Trustees and has co-chaired the AIA "Connecticut Construction" event for the last 10 years. He is the incoming board president of the regional chapter of AIA New England. He also is a member of the National Trust for Historic Preservation, and the Connecticut Trust for Historic Preservation. His design experience includes work for the Biomedical Research Laboratories at Neurogen Corporation in Branford, Connecticut; the Art and Art History Building at Colgate University in Hamilton, New York; the Green Street Arts Center in Middletown, Connecticut; the Upper School Campus at the Buckingham Browne & Nichols School in Cambridge, Massachusetts; and a number of private residences in the Northeast.



Peter Cornell
 Peter Cornell received a BS in Architecture from the University of Virginia in 1991 and a Masters of Architecture from Columbia University in 1996. He initially practiced in New York City, including four years with Bernard

Tschumi Architects working on projects in New York, Miami, and Rouen, France. In 1999 he was hired by Pfau Architecture of San Francisco, and in 2006 he joined Centerbrook Architects, where he has been part of design teams for the Bruce Museum in Greenwich Connecticut, the Center for Community at the University of Colorado, the Hershey Building at Cold Spring Harbor Laboratory in New York, and the LancasterHistory.org Campus of History. Several buildings he worked on have been published in *Architectural Record* and *Interior Design*. He previously served as the president of the Northern California chapter of the Columbia alumni association. He is a licensed architect in Connecticut and a LEED accredited professional.

For more information about Centerbrook, visit their website, www.centerbrook.com

Lead Donors

- Thank you to our early supporters of the Lancaster Campus of History
- Commonwealth of Pennsylvania
 - Michael L. Abel
 - William W. and Susan C. Adams
 - Marguerite S.V. Adams
 - Andrew Appel
 - Barley Snyder LLC
 - Michael Birkner, Ph.D.
 - Mr. and Mrs. Richard Blakinger, Esq.
 - Margot L. Brubaker
 - Mrs. Raymond B. Buckwalter
 - Mary S. Burton and Mr. Laurent N. Horne
 - Caldwell, Heckles, and Egan
 - Patrick and Linda Castagna
 - Robert E. Coda
 - Thomas Hills Cook
 - The Estate of Fianna L. Diffenderfer
 - Mr. and Mrs. Graydon A. Dodson
 - J. Thomas and Janice Dunlevy
 - Dr. Wendell L. Funk
 - Eugene and Bernadette Gardner
 - Eugene and Anne Gardner
 - Marian R. Gerhart
 - Robert and Rhoda Glover
 - Abbie and Ely Gonnick
 - Kathleen A. Gray, Esq.
 - Robert F. and Ellen A. Groff
 - Robert and Aileen Hamilton
 - Randolph and Martha Harris
 - The S. Dale High Family Foundation
 - Dale and Sadie High
 - Leroy T. Hopkins, Jr., Ph.D.
 - Kenneth and Wendy Huber
 - Peter and Barbara Hunsberger
 - The E. Ann Klein Charitable Trust
 - William E. Krantz
 - Robert and Hale Krasne
 - Gregory and Carol Lefever
 - The Estate of Charles Lentz
 - Todd and Heather Lindsley
 - John W.W. Loose
 - Tim and Sue Mackey
 - George and Leslie Mann
 - James H. and Deborah M. Martin
 - Sam Mecum and Deb Frantz
 - Charles and Molly Milner
 - Milton K. and Lois Morgan
 - National Endowment for the Humanities
 - The Pennsylvania Historical and Museum Commission
 - PPL
 - William and Karyn Regitz
 - Kenneth Richards
 - Paul and Cassandra Ripple
 - Rick and Jessica Rodgers
 - The Thomas A. and Georgina T. Russo Family Foundation
 - Thomas R. Ryan, Ph.D.
 - Bruce P. Ryder, Esq.
 - Mr. and Mrs. Donald E. Santarelli
 - Robin E. Sarratt
 - David Schuyler, Ph.D.
 - Leo and Ginger Shelley
 - Willis and Elsie Shenk Foundation
 - Mrs. Sarah Slaymaker
 - The James Hale Steinman Foundation
 - The John Frederick Steinman Foundation
 - John and Mary Stefan
 - Kenneth and Susan Stoult
 - Daniel and Ellen Strickler, Jr.
 - The Charles Y. Tanger Trust
 - Carol Thompson and W. Fred Kinsey, Ph.D.
 - Joseph and Brenda Timko
 - Urban Enhancement Fund, Lancaster County Planning Commission
 - Reverend and Mrs. Frederick Vanderpoel
 - The Richard C. Von Hess Foundation
 - Paul W. and Judy S. Ware
 - Philip R. Wenger and Steven T. Dinnocenti
 - Susan O. Wood
 - Andy and Patti Woolworth